

Case Study

Mars Wrigley, Ballarat

Access Stairs, Platforms and Crossovers

Modular components provide a sweet solution

Project
Mars Wrigley, VIC

Installer
PJM Engineering

Products
KOMBI Crossover Platform Systems

Situation

The Ballarat production facility of Mars Wrigley currently exports to 17 countries and started producing M&Ms in 1986. Last year alone it manufactured more than 5 billion M&Ms – a distance equivalent of travelling around Australia 3.5 times!

Access systems were required for the existing roof top HVAC (Heating, Ventilation and Air Conditioning) plant. Large pipes hindered easy access to the equipment making maintenance extremely difficult for personnel. A sloping roof pitch added to the complexity of the project as did the tight clearances around, over and under piping.

Solution

An existing customer, when PJM made contact with our team they were unsure which products would be suitable, given the restricted access around the existing HVAC systems already in place.

With the use of the KOMBI Builda SAYFA designed some initial concepts which were presented to the client and approval given. The SAYFA Design Team then produced fully detailed and engineered design drawings specifically to accommodate the existing pipework and the degree of roof incline.

Although site measurements had been taken prior to manufacture there are often miscalculations, particularly when dealing with intricate pipeline networks. With KOMBI, on-site modifications could be easily made using the patented KOMBI T-Bolt.

This was definitely a comforting factor for the installer and ensured an easy and trouble free installation.

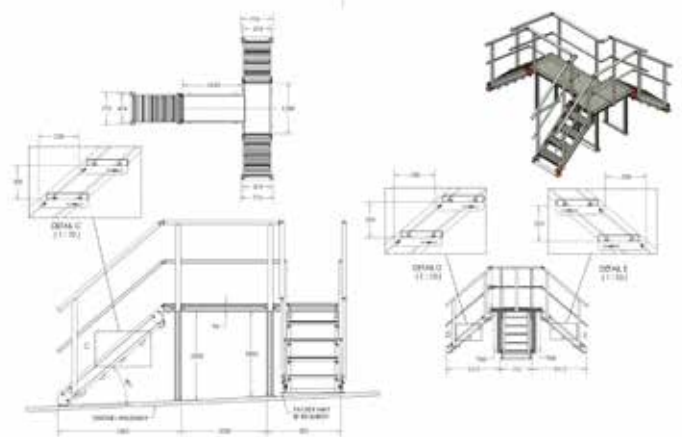

KOMBI
MODULAR ACCESS

SMARTER - EASIER - FASTER